**Description:**

- strainer in flange design
- working pressure: PN16
- angular seated design (Y-form)
- face-to-face length acc. to DIN EN558-1, series 1
- installation position with filter downward
- flange connection acc. to EN1092-1
- metal sealing

**Range of application:**

- Used as filters in fluids and gases in front of valves for protection from dirt in the medium.
- Media temperature depending on the type:
  - grey cast iron: -10°C up to +300°C
  - cast steel: -10°C up to +400°C
  - cast iron with spheroidal graphite: -10°C up to +350°C
  - stainless steel: -10°C up to +300°C

**Comments:**

Different flange connections and pressure ranges are possible:

- flange design PN10 possible (type grey cast iron)
- flange design PN25 from DN65 possible (type cast iron with spheroidal graphite)
- flange design PN40 from DN65 possible (type stainless steel)
- ANSI design possible in 150lbs and 300lbs

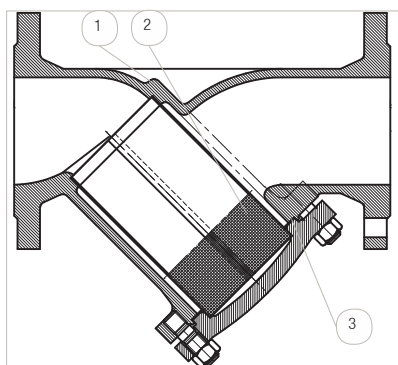

pos.	part	grey cast iron	cast steel		cast iron with spheroidal graphite		stainless steel		
1	body + cover	GG25	L	GSC25	K	GGG40	M	1.4408	O
3	sealing	graphite	R	graphite	R	graphite	R	graphite	R
2	mesh	1.4301	P	1.4301	P	1.4301	P	1.4408	O

For details about the order code see "Order information". An overview of the complete material code you can find at the beginning of each product section of the product catalogue.

**options:**

- FS: fine mesh (smallest mesh size 0,1mm)
- DS: double mesh

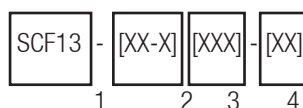
**Order information:****1: type: SCF13****2: connection size (see table):**

- DIN: 52-65 (standard)      ANSI: 82-95
- attached is the nominal pressure of the flange (see table):
  - 0 = PN10
  - 1 = PN16
  - 2 = PN25
  - 3 = PN40

**3: materials**

- 1. digit: body
  - L = grey cast iron
  - K = cast steel
  - M = cast iron with spheroidal graphite
  - O = stainless steel

- 2. digit: sealing:
  - R = metallic sealing (graphite)
- 3. digit: body
  - P = stainless steel V2A
  - O = stainless steel V4A
- attached to mesh size in 100µm:
  - 6 = 600µm      ....      12 = 1200µm (= 1,2mm)

**4: options: none**

Please ask for field specifications that are not listed in this data sheet.

Before installation please consider the installation and maintenance manual, especially the safety indications!

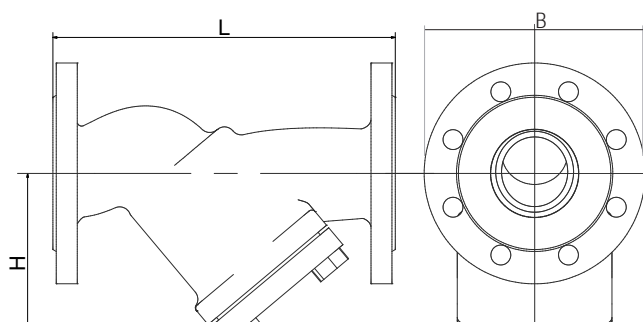

grey cast iron design / cast iron with spheroidal graphite design:

match code	connection size	working pressure [bar] type grey cast iron (LMP)			working pressure [bar] type cast iron with spheroidal graphite			L [mm]	B [mm]	H [mm]	weight [kg]	mesh size [µm]		
			max. at 200°C	max. at 250°C	max. at 300°C		max. at 200°C						max. at 250°C	max. at 300°C
SCF13-52-x xRP-6	DN15	0-16	12.8	11.2	9.6	0-25	20	18	16	acc. to EN1092-1	75	2.4	600	
SCF13-53-x xRP-6	DN20	0-16	12.8	11.2	9.6	0-25	20	18	16		75	3.3	600	
SCF13-54-x xRP-8	DN25	0-16	12.8	11.2	9.6	0-25	20	18	16		90	3.8	800	
SCF13-55-x xRP-8	DN32	0-16	12.8	11.2	9.6	0-25	20	18	16		90	5	800	
SCF13-56-x xRP-8	DN40	0-16	12.8	11.2	9.6	0-25	20	18	16		110	6.5	800	
SCF13-57-x xRP-8	DN50	0-16	12.8	11.2	9.6	0-25	20	18	16		120	9.6	800	
SCF13-58-x xRP-8	DN65	0-16	12.8	11.2	9.6	0-16	20	18	16		140	12.5	800	
SCF13-59-x xRP-12	DN80	0-16	12.8	11.2	9.6	0-16	20	18	16		165	18	1200	
SCF13-60-x xRP-12	DN100	0-16	12.8	11.2	9.6	0-16	20	18	16		220	25	1200	
SCF13-61-x xRP-12	DN125	0-16	12.8	11.2	9.6	0-16	20	18	16		260	39	1200	
SCF13-62-x xRP-12	DN150	0-16	12.8	11.2	9.6	0-16	20	18	16		300	61	1200	
SCF13-63-x xRP-12	DN200	0-16	12.8	11.2	9.6	0-16	20	18	16		360	109	1200	
SCF13-64-x xRP-12	DN250	0-16	12.8	11.2	9.6	0-16	20	18	16		470	162	1200	
SCF13-65-x xRP-12	DN300	0-16	12.8	11.2	9.6	0-16	20	18	16		560	280	1200	

cast steel design / stainless steel design:

match code	connection size	working pressure [bar] type cast steel (KRP)			working pressure [bar] type stainless steel (OMO)			L [mm]	B [mm]	H [mm]	weight [kg]	mesh size [µm]		
			max. at 200°C	max. at 300°C	max. at 400°C		max. at 100°C						max. at 200°C	max. at 300°C
SCF13-52-x xRx-6	DN15	0-40	35	28	21	0-40	32	25	21	acc. to EN1092-1	70	2.8	600	
SCF13-53-x xRx-6	DN20	0-40	35	28	21	0-40	32	25	21		80	3.8	600	
SCF13-54-x xRx-8	DN25	0-40	35	28	21	0-40	32	25	21		88	4.8	800	
SCF13-55-x xRx-8	DN32	0-40	35	28	21	0-40	32	25	21		100	7.3	800	
SCF13-56-x xRx-8	DN40	0-40	35	28	21	0-40	32	25	21		125	8.5	800	
SCF13-57-x xRx-8	DN50	0-40	35	28	21	0-40	32	25	21		140	11	800	
SCF13-58-x xRx-8	DN65	0-16/40	14/35	11/28	8 / 21	0-16	13	10	8.5		170	16	800	
SCF13-59-x xRx-12	DN80	0-16/40	14/35	11/28	8 / 21	0-16	13	10	8.5		190	22.5	1200	
SCF13-60-x xRx-12	DN100	0-16/40	14/35	11/28	8 / 21	0-16	13	10	8.5		225	33.5	1200	
SCF13-61-x xRx-12	DN125	0-16/40	14/35	11/28	8 / 21	0-16	13	10	8.5		260	60.5	1200	
SCF13-62-x xRx-12	DN150	0-16/40	14/35	11/28	8 / 21	0-16	13	10	8.5		320	91.5	1200	
SCF13-63-x xRx-12	DN200	0-16/40	14/35	11/28	8 / 21	0-16	13	10	8.5		420	124.5	1200	
SCF13-64-x xRx-12	DN250	0-16/40	14/35	11/28	8 / 21	0-16	13	10	8.5		495	210	1200	
SCF13-65-x xRx-12	DN300	0-16	12.8	11.2	9.6	0-16	20	18	16		560	280	1200	