

**Description:**

- angular seated design (Y-type)
- female thread acc. to DIN ISO 228
- defined flow direction  
(marked on the body with an arrow)
- installation position with filter downward

**Range of application:**

- Used as filters in fluids and gases in front of valves for protection from dirt in the medium.
- working pressure: PN16
- medium temperature: +100°C
- mesh size: 100/300/800µm
- for neutral media

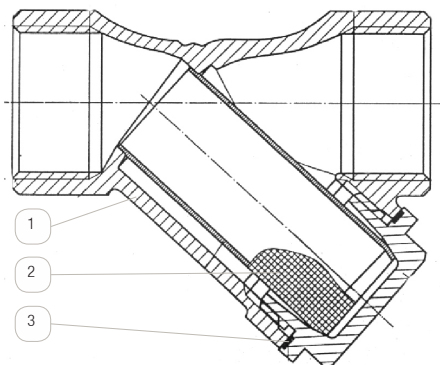

For details about the order code see "Order information".  
An overview of the complete material code you can find at the beginning of each product section of the product catalogue.

pos.	part	material	
1	body + cover	brass	A
3	sealing	NBR	B
2	mesh	1.4301	P

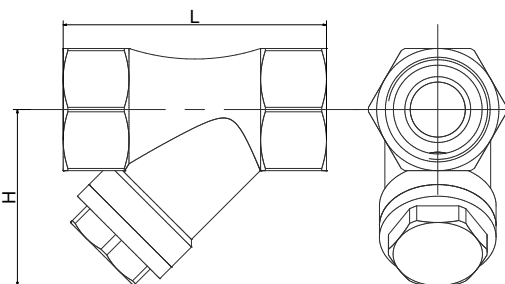

match code	connection size [inch]	nominal size [mm]	working pres- sure [bar]	L [mm]	H [mm]	weight [kg]	CV value [m³/h]
SCA08-04ABP-x	1/2	15	0-16	57	36.6	0.15	4.48
SCA08-05ABP-x	3/4	20	0-16	70	44	0.25	7.86
SCA08-06ABP-x	1	25	0-16	78	49.9	0.43	11.08
SCA08-07ABP-x	1 1/4	32	0-16	97	60.82	0.6	16
SCA08-08ABP-x	1 1/2	40	0-16	106	72.21	0.75	22.28
SCA08-09ABP-x	2	50	0-16	126	n/a	1.4	25.37

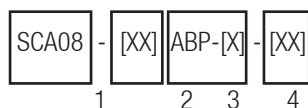
**Order information:****1: type: SCA08****2: connection size (see table): 04-09****3: materials**

- 1. digit: body  
A = brass
- 2. digit: sealing  
B = NBR
- 3. digit: mesh  
P = stainless steel V2A

- attached is the mesh size in 100 micron:  
1 = 100µm  
3 = 300µm  
8 = 800µm

**4: options: none**

Please ask for field specifications that are not listed in this data sheet.

Before installation please consider the installation and maintenance manual, especially the safety indications!