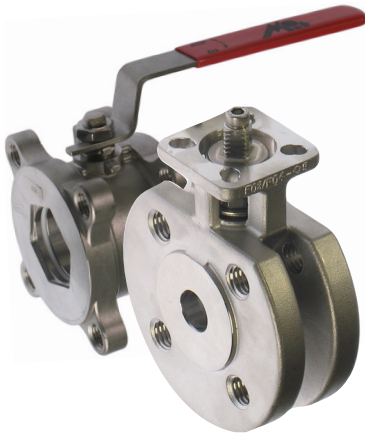

2-WAY COMPACT BALL VALVE, MANUALLY OPERATED AND WITH MOUNTING FLANGE (ECO)

**Description:**

- 2-way ball valve
- compact design
- full passageway up to DN100
- flange acc. to EN1092 -1 / PN40 and PN16
- KFA25: stainless steel hand lever
- KFA23: free spindle / automatable with top flange acc. to EN ISO 5211
- blow out safe, spindle mounted from inside
- any installation position
- minimal clearance volume design (KFA25)
- 2 spot antistatic device (KFA23)

Range of application:

- economical ball valve with flanges with optimized use of body material
- compact design for space-saving installation
- working pressure PN16 - PN40 (see pressure-temperature-diagram)
- temperature range: -10°C up to +200°C (see pressure temperature diagram)

Comments:

KFA25 is the economical manually operated type. KFA23 can be directly automated.

Cast steel design (KFA23) is available on request. Automation of size DN200 on request.

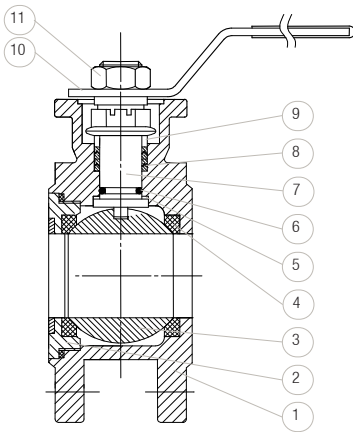

| pos. | part | standard material | | optional material | |
|------|---------------------|-------------------------------|---|-------------------|---|
| 1 | body | 1.4408 | 0 | KFA23: 1.0619 | K |
| 2 | connector | 1.4408 | | KFA23: 1.0619 | |
| 3 | ball | 1.4401 | 0 | - | |
| 4 | seat sealing | PTFE - fibre glass reinforced | G | - | |
| 5 | thrust ring | PTFE | | - | |
| 6 | o-ring | FKM | | - | |
| 7 | spindle | 1.4401 | | - | |
| 8 | packing for spindle | PTFE | T | - | |
| 9 | gland | 1.4301 | | - | |
| 10 | nut | 1.4301 | | - | |
| 11 | handle | 1.4301 | | - | |

options:

- SV: spindle extension
- EB: relief well
- OF: free of oil and grease
- ZG: certificate 3.1
- TD: minimal clearance volume with half shells (KFA23)

For electric actuated valves only:

- AP: accumulator security pack
- PT: potentiometer
- PO: positioning system

For pneumatic actuated valves only:

- SD: sound absorber
- AD: exhaust air regulator
- PV: pilot valve For details see data sheet "GMV3197", "GMV3163" (3/2 way) and "MVA01" (5/2 way). Other types on request.
- PS: positioning indicator For details see data sheet "MCM2" (mechanical), "MCN2" (inductive, with ATEX 94/9/EC) and "MCS2" (inductive). Other types on request.

An overview of the complete material code you can find at the beginning of each product section of the product catalogue.

Pressure temperature diagram

The pressure temperature diagram refers to the ball valve of this type. For the actuated units the actuator limits the permissible pressure range to the operating pressure as indicated above, as long as this is lower than the pressure range of the ball valve. If your application has strong temperature variations, you may need additional options like a relief well, to meet the figures. Please tell us your temperature variations with your order.

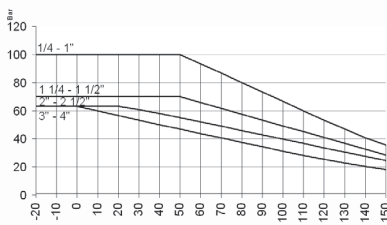

2-WAY COMPACT BALL VALVE, MANUALLY OPERATED AND WITH MOUNTING FLANGE (ECO)

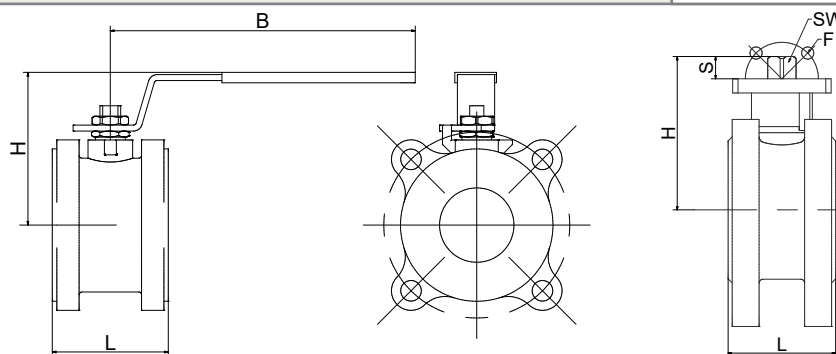

| match code | size | nominal pressure | nominal size [mm] | L [mm] | H [mm] | B [mm] | F | SW* | S | breakaway torque*** [Nm] | CV** [m³/h] | weight [kg] |
|----------------|-------|------------------|-------------------|--------|--------|--------|-----------|-----|------|--------------------------|-------------|-------------|
| KFA25-52-30TOG | DN15 | PN40 | 15 | 40 | 63 | 133 | - | - | - | - | 19.4 | 0.7 |
| KFA25-53-30TOG | DN20 | PN40 | 20 | 44 | 72 | 133 | - | - | - | - | 45.6 | 1 |
| KFA25-54-30TOG | DN25 | PN40 | 25 | 53 | 76 | 133 | - | - | - | - | 71.5 | 1.35 |
| KFA25-55-30TOG | DN32 | PN40 | 32 | 58.4 | 86 | 228 | - | - | - | - | 105 | 2.1 |
| KFA25-56-30TOG | DN40 | PN40 | 38 | 62 | 91 | 228 | - | - | - | - | 170 | 2.45 |
| KFA25-57-30TOG | DN50 | PN40 | 50 | 78 | 98 | 228 | - | - | - | - | 275 | 3.45 |
| KFA25-58-10TOG | DN65 | PN16 | 64 | 100 | 148 | 315 | - | - | - | - | 507 | 6.25 |
| KFA25-59-10TOG | DN80 | PN16 | 76 | 120 | 160 | 315 | - | - | - | - | 905 | 10.05 |
| KFA25-60-10TOG | DN100 | PN16 | 96 | 152 | 180 | 315 | - | - | - | - | 1414 | 15.95 |
| KFA23-52-3xTOG | DN15 | PN40 | 15 | 40 | 68 | - | F03 / F04 | 9 | 9 | 10 | - | - |
| KFA23-53-3xTOG | DN20 | PN40 | 20 | 44 | 75,3 | - | F03 / F04 | 9 | 9 | 13 | - | - |
| KFA23-54-3xTOG | DN25 | PN40 | 25 | 53 | 75,6 | - | F04 / F05 | 11 | 11,5 | 17 | - | - |
| KFA23-55-3xTOG | DN32 | PN40 | 32 | 58,4 | 81,2 | - | F04 / F05 | 11 | 11,5 | 24 | - | - |
| KFA23-56-3xTOG | DN40 | PN40 | 38 | 62 | 93,3 | - | F05 / F07 | 14 | 15 | 35 | - | - |
| KFA23-57-3xTOG | DN50 | PN40 | 50 | 78 | 100,5 | - | F05 / F07 | 14 | 15 | 54 | - | - |
| KFA23-58-1xTOG | DN65 | PN16 | 64 | 100 | 122 | - | F07 | 17 | 17 | 85 | - | - |
| KFA23-59-1xTOG | DN80 | PN16 | 76 | 120 | 140 | - | F07 | 17 | 17 | 117 | - | - |
| KFA23-60-1xTOG | DN100 | PN16 | 96 | 152 | 153 | - | F07 / F12 | 22 | 22 | 148 | - | - |
| KFA23-61-1xTOG | DN125 | PN16 | 114 | 180 | 193,5 | - | F10 / F12 | 27 | 36 | - | - | - |
| KFA23-62-1xTOG | DN150 | PN16 | 135 | 215 | 208,5 | - | F10 / F12 | 27 | 36 | - | - | - |

* Spindle as square.

**CV value: The nominal flow rate CVs acc. to VDI/VDE 2173 shows the water quantity in cubic meter per hour with the valve fully opened, $\Delta p=1$ and the water temperature between 5°C and 30°C.

***Breakaway torque: all data is determined with water at max Δp and normal ambient temperature. Multiplier for frictional media is 1.3. If your configuration has special sealing material or your application has critical media consultation is obligatory.

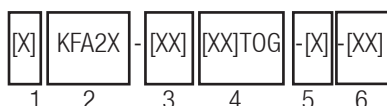

Order information:

1: automation:

- no specification: hand lever (KFA25)
- D: pneumatic double acting (KFA23)
- S: pneumatic single acting (KFA23)
- E: electric actuated (KFA23)

2: type:

- KFA25: manually operated
- KFA23: automated

3: connection size: 52-63 (see table)

4: materials:

- 1. digit: pressure rating
- 2. digit: body material
- 0 = stainless steel

K = cast steel

- 3. digit: sealing for spindle
T = PTFE
- 4. digit: ball material
0 = stainless steel (V4A)
- 5. digit: seat sealing
T = PTFE - fibre glass reinforced

5: actuator:

- no specification: hand lever (KFA25)
free spindle (KFA25)
- automated: see column "actuator" (KFA23)

6: options (see "options")

Please ask for field specifications that are not listed in this data sheet.

Before installation please consider the installation and maintenance manual, especially the safety indications!

DKFA23 / SKFA23

High quality pneumatic actuator made of alloy with air connection according to NAMUR and positioning indicator. The actuator works with the rack/bevel method. For further details see the technical data sheet "DR/SC".

Types double acting (the actuator opens and closes with compressed air) and single acting (the actuator opens with compressed air and closes with spring pressure).

The actuators are configured for use with fluid, gas and antifriction medium. **For critical media it is strictly recommended to inform us!**

Description:

- working pressure: 0 - 16 bar
- medium temperature: -20°C up to +100°C
- pilot pressure: 6 - 8 bar
- (at max. ambient temperature 40°C)

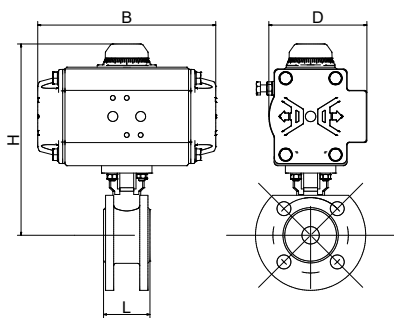

Attention! To avoid corrosion inside the spring chamber for single acting actuators caused by aggressive ambient air we recommend pilot valves with integrated air recirculation.

| match code | double acting: DKFA23 | | | | | single acting: SKFA23 | | | | |
|------------------|-----------------------|-----------|-----------|-----------|----------------|-----------------------|-----------|-----------|-----------|----------------|
| | actuator | H [mm] | B [mm] | D [mm] | weight [kg] | actuator | H [mm] | B [mm] | D [mm] | weight [kg] |
| xKFA23-52-3xTOG- | DR010 | 146 | 118 | 62 | 2.25 | SC030-G | 165 | 153.3 | 84.5 | 3.3 |
| xKFA23-53-3xTOG- | DR015 | 153,3 | 136 | 72 | 3.1 | SC030-I | 158,3 | 153.3 | 84.5 | 3.8 |
| xKFA23-54-3xTOG- | DR015 | 153,6 | 136 | 72 | 3.6 | SC030-K | 169,6 | 153.3 | 84.5 | 4.3 |
| xKFA23-55-3xTOG- | DR030 | 175,2 | 153.5 | 84.5 | 5.3 | SC060-H | 192,2 | 203.5 | 93 | 6.8 |
| xKFA23-56-3xTOG- | DR060 | 198,3 | 203.5 | 93 | 7 | SC060-K | 198,3 | 203.5 | 93 | 7.4 |
| xKFA23-57-3xTOG- | DR060 | 207,5 | 203.5 | 93 | 8.9 | SC100-J | 220,5 | 241 | 106 | 10.5 |
| xKFA23-58-1xTOG- | DR100 | 240 | 241 | 106 | 13.7 | SC220-H | 280 | 304 | 136 | 19.3 |
| xKFA23-59-1xTOG- | DR150 | 270 | 259 | 118 | 19.6 | SC220-K | 298 | 304 | 136 | 23.7 |
| xKFA23-60-1xTOG- | DR220 | 307 | 304 | 136 | 28.6 | SC300-I | 319 | 333 | 146.5 | 32.6 |
| xKFA23-61-1xTOG- | DR450 | 364,5 | 394.5 | 166 | n/a | SC600-J | 383,5 | 474 | 200 | n/a |
| xKFA23-52-3xTOG- | DR450 | 379,5 | 394.5 | 166 | n/a | SC600-J | 398,5 | 474 | 200 | n/a |

EKFA23:

High-quality electric actuator in compact design with a body made of high-strength plastics. It has a high-performance motor and a gear drive made of metal. A central control room heater and an electronic torque limiter are equipped as standard. For further details see the technical data sheet "J".

Description:

- working pressure: 0 - 16 bar
- medium temperature: -20°C up to +70°C (at max. ambient temperature of 40°C)

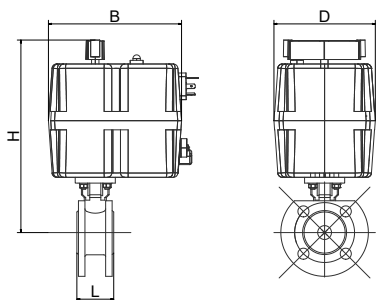
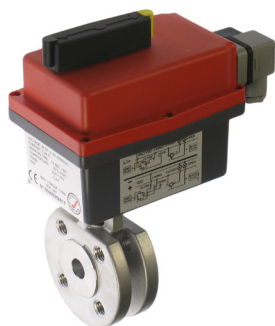

| match code | actuator | H [mm] | B [mm] | D [mm] | weight [kg] |
|------------------|----------|-----------|-----------|-----------|----------------|
| EKFA23-52-3xTOG- | J210 | 186,5 | 169 | 104 | 2.25 |
| EKFA23-53-3xTOG- | J420 | 213,3 | 177 | 110 | 3.5 |
| EKFA23-54-3xTOG- | J420 | 213,6 | 177 | 110 | 4 |
| EKFA23-55-3xTOG- | J435 | 241,2 | 177 | 110 | 5.4 |
| EKFA23-56-3xTOG- | J455 | 272,3 | 177 | 110 | 6.6 |
| EKFA23-57-3xTOG- | J455 | 281,5 | 177 | 110 | 8.5 |
| EKFA23-58-1xTOG- | J485 | 301 | 177 | 110 | 12.8 |
| EKFA23-59-1xTOG- | J2140 | 377 | 235 | 214 | 19.6 |
| EKFA23-60-1xTOG- | J2140 | 386 | 235 | 214 | 25.8 |
| EKFA23-61-1xTOG- | CH350 | 531,5 | 338 | 229 | n/a |
| EKFA23-62-1xTOG- | CH350 | 546,5 | 338 | 229 | n/a |

AC/DC Beschaltung
(3 Draht):

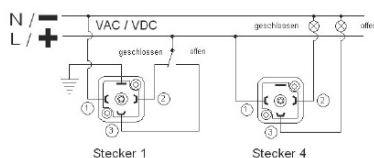
**connection voltage type:**

- 19: 24V AC/DC up to 240V AC/DC
- other voltages on request