

**Description:**

- independent of upstream pressure
- spring-loaded
- downstream pressure adjustable
- female thread acc. to ISO 228
- soft sealing on the cone
- variable setting range

Range of application:

- pressure control
- steam, gases and fluids
- working pressure depending on sealing material
FKM: -20°C up to 200°C
- recommended reduction ratio:
 - min: $P1/P2 = 1,1$
P1= upstream pressure
 - max: $P1/P2 = 40$
P2 = downstream pressure

Comments:

Threads according to EN 228: It describes the threaded connection of a parallel male thread with a parallel female thread and is marked with "G".

Other **pressure ranges** on request. **Flange design** on request.

Optionally with **pressure gauge** (connection G1/4", rear) or with **brazed union**.

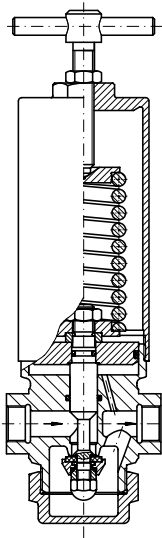

pos.	part	stainless steel V2A		stainless steel V4A	options		
1	body	1.4301	P	1.4571 (0)	0		
2	interior	stainless steel		stainless steel			
3	cone	PTFE		PTFE	PA		
4	sealing	FKM	V	FKM	V		

options:

- -

spare parts:

- 060: complete cone kit
- 081: spring
- 350-352: o-ring kit FKM
- 356, 264, 381: sealing rings PTFE

For details about the order code see "Order information". An overview of the complete material code you can find at the beginning of each product section of the product catalogue.

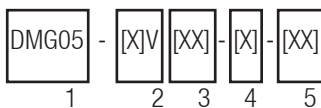
**Order information:**

1: type: DMG05

2: connection size (see table): 01-10

3: materials:

- 1. digit: body material
P=stainless steel V2A
O=stainless steel V4A
- 2. digit: sealing: V = FKM

4: max. upstream pressure:

- 1: PN16
- 3: PN40
- 4: PN63
- 5: PN100

5: options: none

Please specify when ordering the required downstream pressure!

Please ask for field specifications that are not listed in this data sheet.

Before installation please consider the installation and maintenance manual, especially the safety indications!

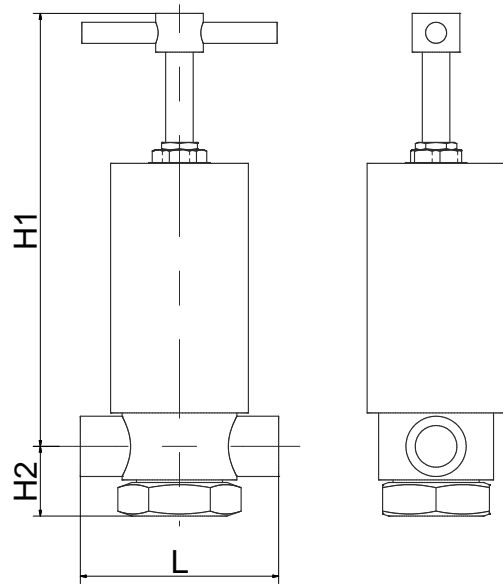

match code	connection size [inch]	upstream pressure maximum [bar]	downstream pressure setting range [bar]	L [mm]	H1 [mm]	H2 [mm]	weight [kg]
DMG05-01xV-1*	1/8	16	1 - 7.7	58	149	36	1.1
DMG05-02xV-1*	1/4	16	1 - 7.7	58	149	36	1.1
DMG05-02xV-4***	1/4	63	0.35 - 14.4	70	205	48	1.8
DMG05-03xV-4	3/8	63	0.35 - 14.4	70	205	48	1.8
DMG05-04xV-4***	1/2	63	0.35 - 14.4	70	205	48	1.8
DMG05-04xV-5	1/2	100	0.35 - 52	90	275	58	3.7
DMG05-05xV-4	3/4	63	0.35 - 52	90	275	58	3.7
DMG05-06xV-4***	1	63	0.35 - 52	135	275	58	3.7
DMG05-06xV-4	1	63	0.25 - 23	105	300	68	5.2
DMG05-07xV-4	1 1/4	63	0.25 - 23	105	300	68	5.2
DMG05-08xV-4***	1 1/2	63	0.25 - 23	155	300	68	5.2
DMG05-08xV-4**	1 1/2	63	0.25 - 18.8	145	325	85	9.6
DMG05-09xV-3**	2	40	0.25 - 18.8	145	325	85	9.6
DMG05-10xV-3**/***	2 1/2	40	0.25 - 18.8	210	325	85	9.6
DMG05-09xV-3**	2	40	0.25 - 12	220	540	145	27
DMG05-10xV-3**	2 1/2	40	0.25 - 12	220	540	145	27

*not applicable for steam

**only available in material 1.4571 (0)

***special size

SUPPLEMENT: SETTING RANGES

Relief capacity at 10% pressure surge for each set pressure for each size measured with water in kg/h for **liquids**.

comment:

The valve spring can be relaxed beneath the specified minimum value of the outlet pressure range.

However, note that the percental control tolerance increases with smaller outlet pressures.

connection size	standard	1/8	1/4	3/8		1/2	3/4	1	1 1/4	1 1/2	2	2	2 1/2
[inch]	special size			1/4	1/2	1		1 1/2		2 1/2			
piston plate [mm]													
Ø119													0.25 - 0.44 0.35 - 0.73 0.5 - 1.1 0.8 - 1.65 1.3 - 2.65 1.9 - 3.85
Ø99										0.25 - 0.47 0.36 - 0.72 0.57 - 1.15 1.00 - 2.00			0.8 - 1.6 1.2 - 2.4 1.9 - 3.8 2.8 - 5.6
Ø84								0.25 - 0.5 0.4 - 0.83 0.65 - 1.3 1.00 - 2.00 1.4 - 2.8		0.8 - 1.6 1.4 - 2.8 1.6 - 3.2			2.6 - 5.3 3.8 - 7.7 4.5 - 9.1 6.0 - 12.0
Ø64				0.35 - 0.6 0.4 - 0.9 0.6 - 1.3 0.8 - 1.7 1.00 - 2.2		0.35 - 0.54 0.5 - 0.94 0.7 - 1.5 1.00 - 2.4 1.8 - 3.8 2.6 - 5.3		1.7 - 3.5 2.4 - 4.8 3.0 - 6.1		1.4 - 2.8 2.4 - 4.8 2.7 - 5.4 3.5 - 6.9			
Ø48				1.2 - 2.4 1.5 - 3.1 1.9 - 3.9		3.3 - 6.7 4.7 - 9.5 6 - 12.2		3.0 - 6.1 4.3 - 8.6 5.5 - 11 7.5 - 14.5		4.2 - 8.5 4.8 - 9.6 6.5 - 12.3 9.5 - 18.8			
Ø38		1.00 - 1.7 1.4 - 2.7 1.7 - 3.3 1.8 - 3.5 2.0 - 4.0 2.4 - 4.8 2.7 - 5.3 2.8 - 5.6 3.5 - 6.2 5.0 - 7.2		1.3 - 2.5 1.9 - 3.8 2.5 - 5 3 - 6.1		5.4 - 10.7 7.5 - 15 10 - 19.5 13 - 26		5 - 9.8 7 - 13.8 9 - 17.5 12.0 - 23.0					
Ø27				2.5 - 5 3.7 - 7.5 5 - 9.8 6 - 12.2 7 - 14.4		11.0 - 21.0 15.0 - 30.0 20.0 - 38.0 26.0 - 52.0							