

BUTTERFLY VALVE, WAFER TYPE / LUG TYPE

**Description:**

- Butterfly valve KLA10: wafer type
KLC10: lug type
- 2-part spindle
- flanges PN16 acc. to EN1092-1
- latching hand lever, from DN250 hand gear
- top flange acc. to EN ISO 5211
- central disc position
- any installation position

Range of application:

- max pressure difference PN16 (DN25 up to DN150) and PN10 (from DN200). (see pressure-temperature-diagram)
- temperature range: -10°C up to +80°C and higher temperatures with other sealing.
- with top flange for direct pneumatic or electric automation
- for heating and industrial applications
- suitable for drinking water with EPDM collar and disc made of 1.4581 (DVGW certified)

picture behind: KLC10 with latching hand lever
picture in front: KLA10 with free spindle

Comments:

The butterfly valves can be directly automated. In addition to the standard, you can also order the valves with nominal flange pressure PN6 or PN10. Other sealings on request.

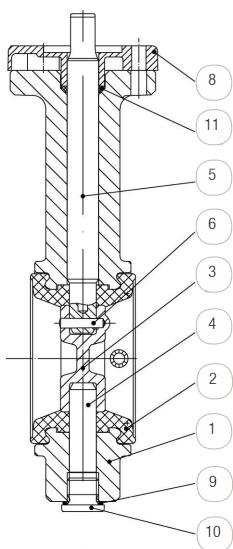

pos.	part	standard material		optional material	
1	body	EN-GJS-40015 (GGG40)	M		
2	collar	NBR	B	EPDM	E
				FKM	V
3	disc	up to DN100: 1.4581	O	1.4581 from DN100	O
		from DN100: EN-GJS-40015 (GGG40)	M		
		coated			
4	pin	1.4021 + QT		1.4571	
5	spindle	1.4021 + QT		1.4571	
6	taper pin	1.4571			
8	isolation cap	PA 6			
9	sealing ring	Cu			
10	lock screw	5.8-A2G			
11	o-ring	NBR	B	EPDM	E
				FKM	V

For details about the order code see "Order information". An overview of the complete material code you can find at the beginning of each product section of the product catalogue.

Differing medium temperature for other sealing material:

- EPDM: -10°C up to +130°C
- FKM: -10°C up to +150°C

Options:

- HG: hand gear
- FW: free spindle
- SF: free of silicone

For electric actuated valves only:

- AP: accumulator security pack
- PT: potentiometer
- PO: positioning system

For pneumatic actuated valves only:

- SD: sound absorber
- AD: exhaust air regulator
- HT: actuator for high-temperatures
- PV: pilot valve For details see data sheet "GMV3197", "GMV3163" (3/2 way) and "MVA01" (5/2 way). Other types on request.
- PS: positioning indicator
For details see data sheet "MCM2" (mechanical), "MCN2" (inductive, with ATEX 94/9/EC) and "MCS2" (inductive). Other types on request.

BUTTERFLY VALVE, WAFER TYPE / LUG TYPE

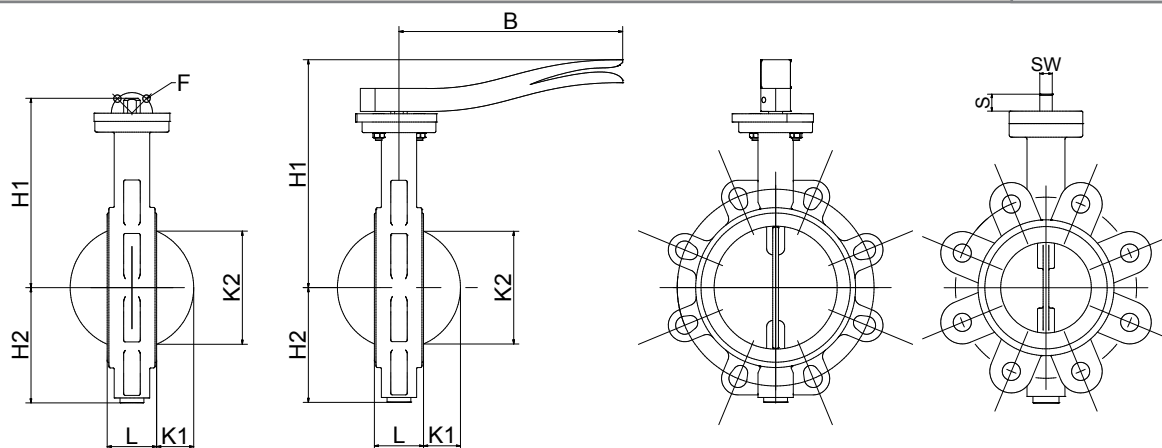

match code	size [inch]	max. pres- sure diffe- rence	L [mm]	H1 [mm]		H2 [mm]	K1 [mm]	K2 [mm]	B [mm]	F	SW*	S [mm]	CV** [m³/h]	zeta value ***	breakaway torque**** [Nm]	weight [kg]	
					-FW											KLA10	KLC10
KLx10-54-1Mx0x	DN25	PN16	33	187	128	58	-	-	184	F05	11ZF	15	26	0.93	8	1.8	2.2
KLx10-55-1Mx0x	DN32	PN16	33	187	128	58	-	-	184	F05	11ZF	15	26.5	2.4	8	1.8	2.2
KLx10-56-1Mx0x	DN40	PN16	33	193	134	66	5	26	184	F05	11ZF	15	49.6	1.7	12	2	2.4
KLx10-57-1Mx0x	DN50	PN16	43	199	140	69	5	29	184	F05	11ZF	15	116	0.75	15	2.4	3.2
KLx10-58-1Mx0x	DN65	PN16	46	209	150	81	11	49	184	F05	11ZF	15	259	0.43	25	3	3.6
KLx10-59-1Mx0x	DN80	PN16	46	217	158	100	18	68	184	F05	11ZF	15	377	0.46	35	3.6	5.2
KLx10-60-1Mxxx	DN100	PN16	52	238	179	109	25	88	184	F05	11ZF	15	763	0.27	50	4.4	6.6
KLx10-61-1Mxxx	DN125	PN16	56	263	196	124	36	115	273	F07	17ZF	18	1030	0.37	100	7.4	9.6
KLx10-62-1Mxxx	DN150	PN16	56	279	212	140	48	142	273	F07	17ZF	18	1790	0.25	110	9.4	11.8
KLx10-63-0Mxxx	DN200	PN10	60	313	246	167	71	194	273	F07	17ZF	18	3460	0.21	135	13.4	16.4
KLx10-64-0Mxxx-HG	DN250	PN10	68	428	273	203	91	243	272	F10	22	24	5070	0.24	250	24.4	29.8
KLx10-65-0Mxxx-HG	DN300	PN10	78	457	302	232	112	292	272	F10	22	24	7430	0.23	450	34.4	41
KLx10-66-0Mxxx-HG	DN350	PN10	78	513	358	258	132	333	272	F10	22	26	10320	0.23	450	49	61
KLx10-67-0Mxxx-HG	DN400	PN10	102	603	407	287	147	383	510	F14	30	42	13290	0.23	650	75.6	97
KLx10-69-0Mxxx-HG	DN500	PN10	127	691	495	354	188	486	510	F14	30	42	21180	0.22	1200	120	157

* Spindle as square (standard). ZF: Spindle as dihedral.

**CV value: The nominal flow rate CVs acc. to VDI/VDE 2173 shows the water quantity in cubic meter per hour with the valve fully opened, $\Delta p=1$ and the water temperature between 5°C and 30°C.

***Zeta value: non-dimensional value, that shows the pressure drop constant for passed through bodies in a piping having the valve fully opened.

****Breakaway torque: all data is determined with water at max Δp and normal ambient temperature. Multiplier for frictional media is 1.3. If your configuration has special sealing material or your application has critical media consultation is obligatory.

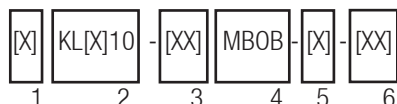

Order information:

1: automation:

- no specification: latching hand lever/ hand gear
- D: pneumatic double acting
- S: pneumatic single acting
- E: electric actuated

2: type:

- KLA10: wafer type
- KLC10: lug type

3: connection size:

- 54 -69 (see table)
- attached is the nominal flange pressure:
0 = PN10
1 = PN16

4: materials:

- 1. digit: body material

M = Cast iron with spheroidal graphite

- 2. digit: spindle sealing
B = NBR (Standard)
E = EPDM
F = FKM
- 3. digit: disc
O = stainless steel
- 4. digit: collar
B = NBR (Standard)
E = EPDM
F = FKM

5: actuator:

- latching hand lever: no specification
- hand gear: option -HG / free spindle: option -FW
- automated: see column "actuator"

6: Options (see "options")

Please ask for field specifications that are not listed in this data sheet.

Before installation please consider the installation and maintenance manual, especially the safety indications!

**DKLA10 / SKLA10 / DKLC10 / SKLC10**

High quality pneumatic actuator made of alloy with air connection according to NAMUR and positioning indicator. The actuator works with the rack/bevel method. For further details see the technical data sheet "DR/SC".

Types double acting (the actuator opens and closes with compressed air) and single acting (the actuator opens with compressed air and closes with spring pressure).

The actuators are configured for use with fluid, gas and antifriction medium. **For critical media it is strictly recommended to inform us!**

Description:

- working pressure: 0 - 16 bar
- pilot pressure: 6 - 8 bar
- ambient temperature: -20°C up to +80°C
- medium temperature: -20°C up to +80°C (150°C with ambient temperature up to 35°C) other temperature conditions upon request.

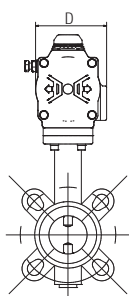
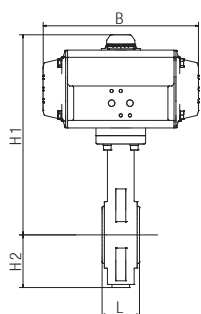

double acting: DKLA10/DKLC10						
match code	actuator	H1 [mm]	B [mm]	D [mm]	weight [kg]	
					DKLA10	DKLC10
DKLx10-54-1Mx0x-	DR030	233	153.5	84.5	3	3.4
DKLx10-55-1Mx0x-	DR030	233	153.5	84.5	3	3.4
DKLx10-56-1Mx0x-	DR030	239	153.5	84.5	3.2	3.6
DKLx10-57-1Mx0x-	DR030	245	153.5	84.5	3.6	4.4
DKLx10-58-1Mx0x-	DR030	255	153.5	84.5	4.2	4.8
DKLx10-59-1Mx0x-	DR030	263	153.5	84.5	4.8	6.4
DKLx10-60-1Mxxx-	DR060	301	203.5	93	6.7	8.9
DKLx10-61-1Mxxx-	DR100	331	241	106	8.3	12.5
DKLx10-62-1Mxxx-	DR100	347	241	106	12.3	14.7
DKLx10-63-0Mxxx-	DR150	393	259	118	17.8	20.8
DKLx10-64-0Mxxx-	DR220	448	304	136	27.4	32.8
DKLx10-65-0Mxxx-	DR450	509	394.5	166	43.4	50
DKLx10-66-0Mxxx-	DR450	565	394.5	166	57.9	69.6
DKLx10-67-0Mxxx-	DR600	633	422.5	181	85.7	103
DKLx10-69-0Mxxx-	DR1200	790	528	221.5	145	180

single acting: SKLA10/SKLC10						
match code	actuator	H1 [mm]	B [mm]	D [mm]	weight [kg]	
					SKLA10	SKLC10
SKLx10-54-1Mx0x-	SC030-G	233	153.5	84.5	3.5	3.5
SKLx10-55-1Mx0x-	SC030-G	233	153.5	84.5	3.5	3.5
SKLx10-56-1Mx0x-	SC030-J	239	153.5	84.5	3.7	3.7
SKLx10-57-1Mx0x-	SC030-K	245	153.5	84.5	4.5	4.5
SKLx10-58-1Mx0x-	SC060-I	272	203.5	93	6.3	6.3
SKLx10-59-1Mx0x-	SC100-H	293	241	106	9.1	9.1
SKLx10-60-1Mxxx-	SC150-I	326	259	118	12.3	12.3
SKLx10-61-1Mxxx-	SC220-K	371	304	136	18.1	18.1
SKLx10-62-1Mxxx-	SC300-I	399	333	146.5	23	23
SKLx10-63-0Mxxx-	SC450-G	533	394.5	166	32.6	32.6
SKLx10-64-0Mxxx-	SC600-K	499	422.5	181	46.8	46.8
SKLx10-65-0Mxxx-	SC1200-I	677	528	221.5	78	78
SKLx10-66-0Mxxx-	SC1200-I	733	528	221.5	97.6	97.6
SKLx10-67-0Mxxx-	SC2000-J	755.5	605	262	152	152
SKLx10-69-0Mxxx-	SC3000-J	875	710	330	239	239

Attention!

To avoid corrosion inside the spring chamber for single acting actuators caused by aggressive ambient air we recommend pilot valves with integrated air recirculation.

**EKLA10 / EKLC10**

High-quality electric actuator in compact design with a body made of high-strength plastics. It has a high-performance motor and a gear drive made of metal. A central control room heater and an electronic torque limiter are equipped as standard. For further details see the technical data sheet "J".

The actuators are configured for use with fluid, gas and antifriction medium. For critical media it is strictly recommended to inform us!

Description:

- working pressure: 0 - 16 bar
- ambient temperature: -20°C up to +70°C
- medium temperature: -20°C up to +80°C
(150°C with ambient temperature up to 35°C)
other temperature conditions upon request.

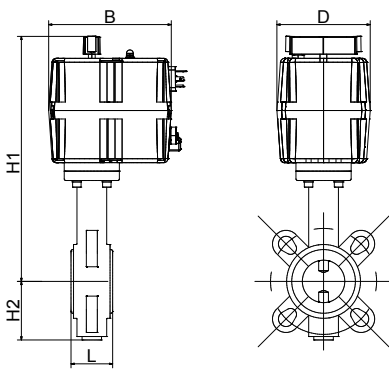

match code	actuator	H1 [mm]	B [mm]	D [mm]	weight [kg]	
					DKLA10	DKLC10
EKLx10-54-1Mx0x-	J210	254.5	169	104	2.15	2.55
EKLx10-55-1Mx0x-	J210	254.5	169	104	2.15	2.55
EKLx10-56-1Mx0x-	J210	260	169	104	2.35	2.75
EKLx10-57-1Mx0x-	J320	289	177	110	3.4	4.2
EKLx10-58-1Mx0x-	J335	321	177	110	4.3	4.9
EKLx10-59-1Mx0x-	J335	329	177	110	4.9	6.5
EKLx10-60-1Mxxx-	J355	375	177	110	6.3	8.5
EKLx10-61-1Mxxx-	J2140	460	235	214	9.8	14
EKLx10-62-1Mxxx-	J2140	476	235	214	13.8	16.2
EKLx10-63-0Mxxx-	J2140	510	235	214	17.8	20.8
EKLx10-64-0Mxxx-	J2300	537	235	214	24.6	30
EKLx10-65-0Mxxx-	CH500	590	357	244	49.4	56
EKLx10-66-0Mxxx-	CH500	646	357	244	63.9	75.6
EKLx10-67-0Mxxx-	CH800	720	380	284	92.7	110
EKLx10-69-0Mxxx-	CH1100	808	380	284	136	171

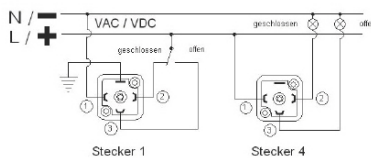
AC/DC Beschaltung
(3 Drahtig):**connection voltage type:**

- 19: 24V AC/DC up to 240V AC/ DC
- other voltages on request